

AC POWER INPUT: 208 - 240 VAC 1 HP & LESS

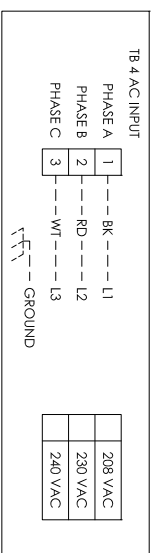

AC POWER INPUT: 208 - 240 VAC 1.5 HP & GREATER & 380 VAC & GREATER

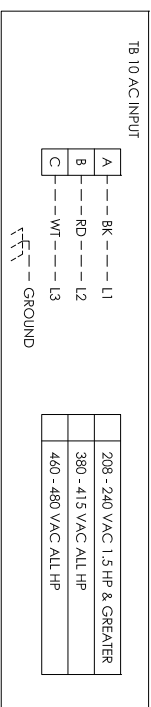

WIRING DIAGRAM FOR KEY SWITCHES IN SERIES

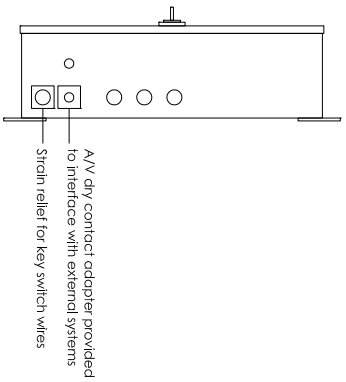
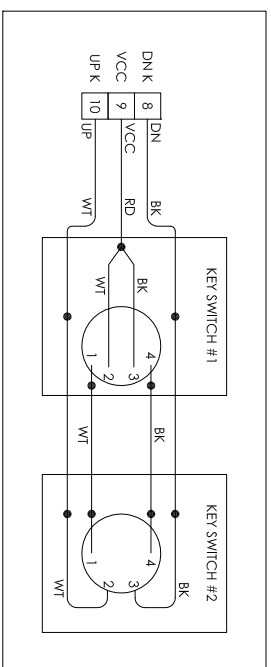

CONTROL BOX (SIDE VIEW)

SCALE: NONE

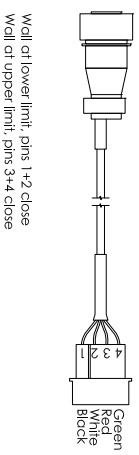

A/V ADAPTER PLUG ASSEMBLY (SOCKET CONNECTOR INCLUDED)

SCALE: NONE

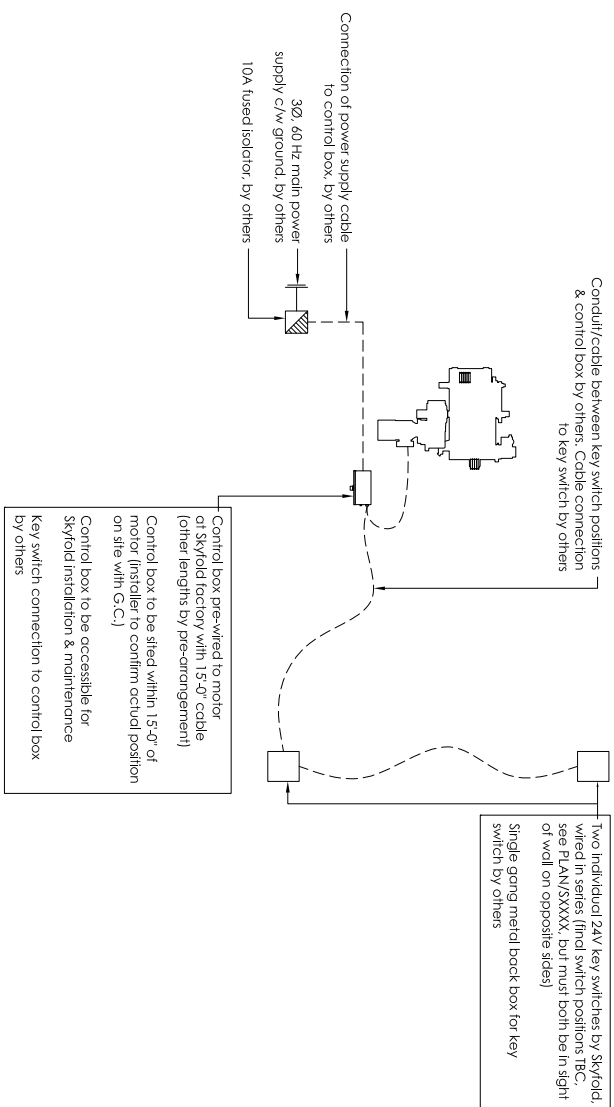

ELECTRICAL PLAN

SCALE: NONE

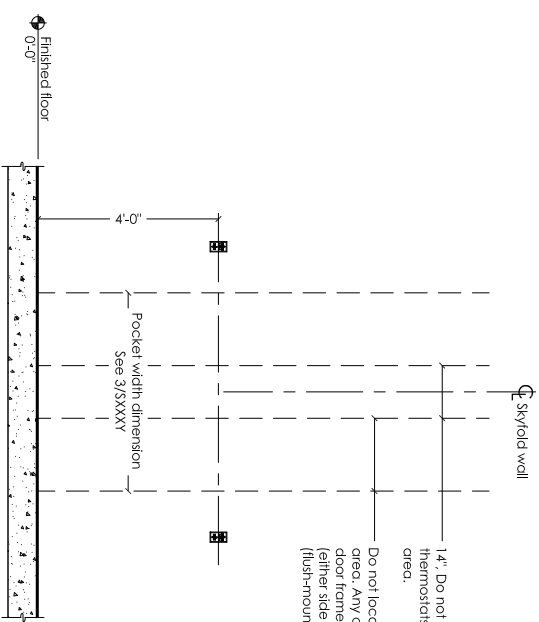

ELEVATION SHOWING KEY SWITCHES

SCALE: 1/2" = 1'-0"

NOTES TO G.C.

1. Specified electrical: 208 VAC, 3Ø, 60 Hz.
* POWER MUST BE AVAILABLE AT TIME OF INSTALLATION.
THE ELECTRICAL CONTROL BOX IS TO BE MOUNTED BY THE ELECTRICAL CONTRACTOR.
2. 24 volt key switch controls & boxes to be installed by electrical contractor as per standard lift/lift switch. Boxes to be fitted at desired key switch location with suitable cable run back through ceiling void to control box position, including sufficient spare to allow connection. Key switches are supplied by Skyfold & are required on each side of the wall.
See PLAN/SXXXX for key switch positions.
3. Motor size: XXXXXXXXXXXXXXXXXXXXXXXXXXXXXXXX
Full load amp: XXXX A
4. Do not scale from this drawing. All dimensions must be verified on site.

Approved Skyfold drawings	Contractor
Project	PROJECT NAME Address 1 Address 2
Drawing title	X @ X'-X" x X'-X" Finished ceiling ELECTRICAL DETAILS
Author	Contractor
Drawn by	Date
Checked project file	Scale
SKY-XXXX	As noted
Drawing title	Revision
SXXXX	0